

IBC30 REPLACEMENT PARTS

△

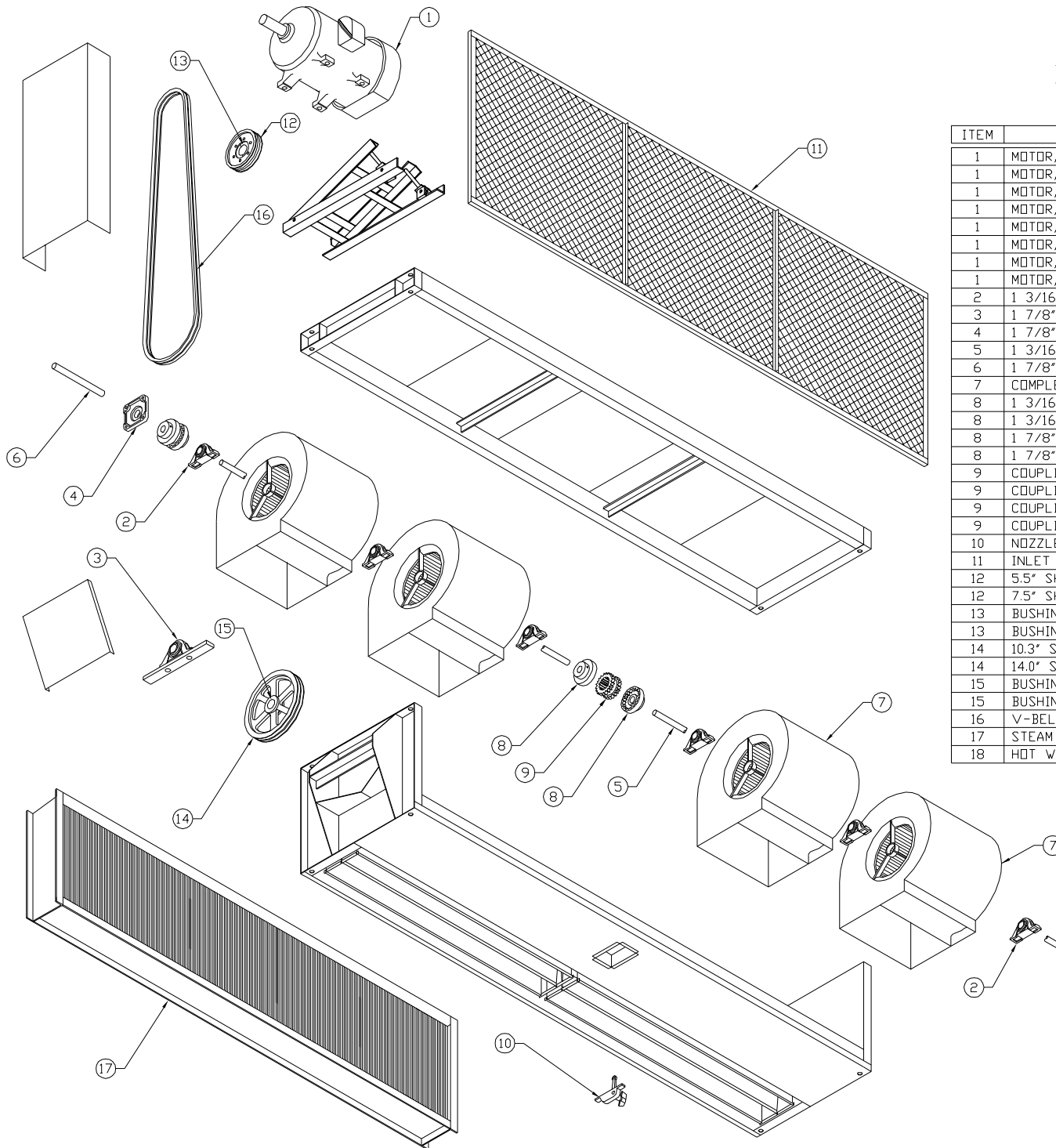

ITEM	DESCRIPTION	PART #
1	MOTOR, 15 HP. T.E.F.C. (208-240/480/3Ø/60)	01015254T1X18G
1	MOTOR, 15 HP. T.E.F.C. (600/3Ø/60)	01015254T1X18I
1	MOTOR, 20 HP. T.E.F.C. (208-240/480/3Ø/60)	01020256T1X18G
1	MOTOR, 20 HP. T.E.F.C. (600/3Ø/60)	01020256T1X18I
1	MOTOR, 25 HP. T.E.F.C. (208-240/480/3Ø/60)	01025284T1X18G
1	MOTOR, 25 HP. T.E.F.C. (600/3Ø/60)	01025284T1X18I
1	MOTOR, 30 HP. T.E.F.C. (208-240/480/3Ø/60)	01030286T1X18G
1	MOTOR, 30 HP. T.E.F.C. (600/3Ø/60)	01030286T1X18I
2	1 3/16" PILLOW BLOCK BEARING	13PB1316
3	1 7/8" PILLOW BLOCK BEARING	13PB1078
4	1 7/8" FLANGE BEARING	13FB1078
5	1 3/16" SHAFT (specify length - inches)	24STL1316-****
6	1 7/8" JACKSHAFT	24EWD1078-11.75
7	COMPLETE BLOWER ASSEMBLY	29B15151515G
8	1 3/16" SHAFT COUPLING FLANGE ONLY, SIZE 6S	146S10316
8	1 3/16" SHAFT COUPLING FLANGE ONLY, SIZE 7S	147S10316
8	1 7/8" SHAFT COUPLING FLANGE ONLY, SIZE 6S	146S1078
8	1 7/8" SHAFT COUPLING FLANGE ONLY, SIZE 7S	147S1078
9	COUPLING SLEEVE ONLY, 6HS HYTREL SPLIT	156HS
9	COUPLING SLEEVE ONLY, 7HS HYTREL SPLIT	157HS
9	COUPLING SLEEVE ONLY, 6JES EPDM SPLIT	156JES
9	COUPLING SLEEVE ONLY, 7JES EPDM SPLIT	157JES
10	NOZZLE ADJUSTMENT OPERATOR	28TH1508
11	INLET SCREEN - FRONT AIR INTAKE (spec length - inches)	08EWD***ISA-F
12	5.5" SHEAVE ONLY (15hp - 20hp)	385V2G055-SDS
12	7.5" SHEAVE ONLY (25hp - 30hp)	385V2G075-SK
13	BUSHING FOR 5.5" SHEAVE	38B1058-SDS
13	BUSHING FOR 7.5" SHEAVE	38B1078-SK
14	10.3" SHEAVE ONLY (15hp - 20hp)	385V2G103-SK
14	14.0" SHEAVE ONLY (25hp - 30hp)	385V2G140-SF
15	BUSHING FOR 10.3" SHEAVE	38B1078-SK
15	BUSHING FOR 14.0" SHEAVE	38B1078-SF
16	V-BELT (specify model/length - inches)	395VX***
17	STEAM COIL (specify length & connection)	Consult Factory
18	HOT WATER COIL (specify length & connection)	Consult Factory

**** SPECIFY SHAFT LENGTH
*** SPECIFY LENGTH (IN INCHES)

SHEET 1 OF 1

PROJECT		
LOCATION		
ARCHITECT		
ENGINEER		REV. A
DWG. NO.	IBC30-RP	TITLE: BERNER
DATE	08JUNE2016	MODEL IBC30 AIR CURTAIN
BY	S. Beil	REPLACEMENT PARTS
REPLACES	11NOV14	
BY	S. Beil	BERNER INTERNATIONAL CORP. NEW CASTLE, PA.