

IDC16/IDC20 REPLACEMENT PARTS

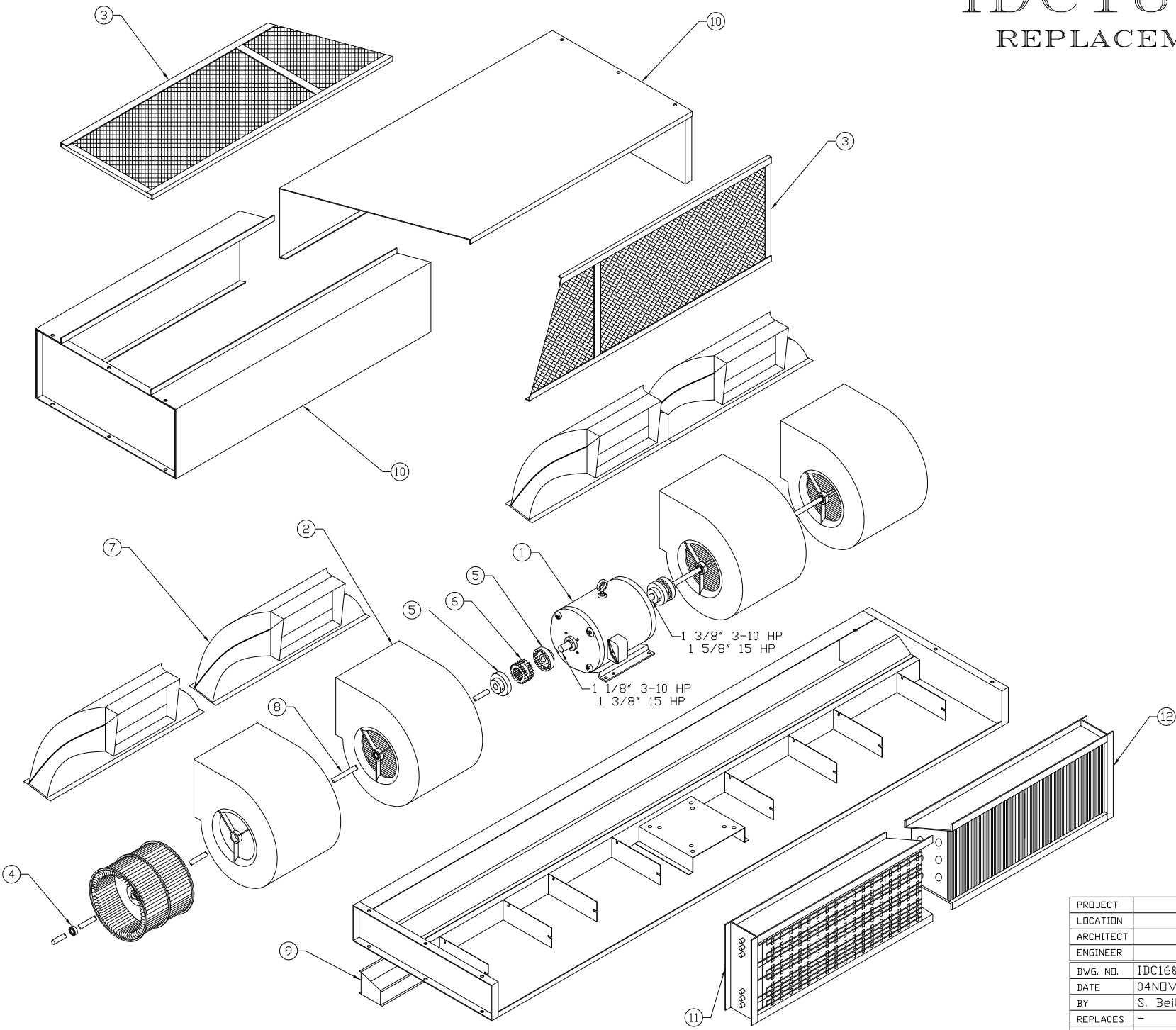

SHEET 1 OF 2

PROJECT		
LOCATION		
ARCHITECT		
ENGINEER		REV. -
DWG. NO.	IDC16&20-RP	TITLE: BERNER
DATE	04NOV14	MODEL IDC16/IDC20 AIR CURTAIN
BY	S. Beil	REPLACEMENT PARTS
REPLACES	-	BERNER INTERNATIONAL CORP. NEW CASTLE, PA.
BY	-	

IDC16 / IDC20 REPLACEMENT PARTS

ITEM	DESCRIPTION	PART #
1	MOTOR, 3 H.P. (208-240/480/3Ø/60)	01005215T1X12G
1	MOTOR, 3 H.P. (600/3Ø/60)	01005215T1X12I
1	MOTOR, 5 H.P. (208-240/480/3Ø/60)	01005215T1X12G
1	MOTOR, 5 H.P. (600/3Ø/60)	01005215T1X12I
1	MOTOR, 7 1/2 H.P. (208-240/480/3Ø/60)	01007256T1X12G
1	MOTOR, 7 1/2 H.P. (600/3Ø/60)	01007256T1X12I
1	MOTOR, 10 H.P. (208-240/480/3Ø/60)	01010256T1X12G
1	MOTOR, 10 H.P. (600/3Ø/60)	01010256T1X12I
1	MOTOR, 15 H.P. (208-240/480/3Ø/60)	01015256T1X12G
1	MOTOR, 15 H.P. (600/3Ø/60)	01015256T1X12I
2	COMPLETE BLOWER ASSEMBLY - IDC16 UNITS ONLY	29B12111010G-A
2	COMPLETE BLOWER ASSEMBLY - IDC20 UNITS ONLY	29B12111211G-A
3	INLET SCREEN ASSEMBLY (specify length & intake - inches)	08CF-***ISA
4	BEARING, RESILIENT MOUNT- 1"	13RM1000
5	1" SHAFT COUPLING FLANGE ONLY, SIZE 6S	146S1000
5	1" SHAFT COUPLING FLANGE ONLY, SIZE 7S	147S1000
5	1 1/8" SHAFT COUPLING FLANGE ONLY, SIZE 6S	146S1018
5	1 3/8" SHAFT COUPLING FLANGE ONLY, SIZE 6S	146S1038
5	1 3/8" SHAFT COUPLING FLANGE ONLY, SIZE 7S	147S1038
5	1 5/8" SHAFT COUPLING FLANGE ONLY, SIZE 6S	146S1058
5	1 5/8" SHAFT COUPLING FLANGE ONLY, SIZE 7S	147S1058
6	COUPLING SLEEVE ONLY, 6JES EPDM SPLIT	156JES
6	COUPLING SLEEVE ONLY, 7JES EPDM SPLIT	157JES
7	COMPLETE DIVERTER ASSEMBLY	17FGDIVA
8	1" SHAFT, (specify length - inches)	24CF-1000-**
9	NOZZLE VANE (specify length - inches)	06CF-***NA
10	TOP COVER, 60", FRONT INTAKE (specify type of heat)	43CF-060TC-AF
10	TOP COVER, 60", TOP INTAKE (specify type of heat)	43CF-060TC-AT
10	TOP COVER, 72", FRONT INTAKE (specify type of heat)	43CF-072TC-AF
10	TOP COVER, 72", TOP INTAKE (specify type of heat)	43CF-072TC-AT
10	TOP COVER, 96", FRONT INTAKE (specify type of heat)	43CF-096TC-AF
10	TOP COVER, 96", TOP INTAKE (specify type of heat)	43CF-096TC-AT
10	TOP COVER, 108", FRONT INTAKE (specify type of heat)	43CF-108TC-AF
10	TOP COVER, 108", TOP INTAKE (specify type of heat)	43CF-108TC-AT
10	TOP COVER, 120", FRONT INTAKE (specify type of heat)	43CF-120TC-AF
10	TOP COVER, 120", TOP INTAKE (specify type of heat)	43CF-120TC-AT
10	TOP COVER, 132", FRONT INTAKE (specify type of heat)	43CF-132TC-AF
10	TOP COVER, 132", TOP INTAKE (specify type of heat)	43CF-132TC-AT
10	TOP COVER, 144", FRONT INTAKE (specify type of heat)	43CF-144TC-AF
10	TOP COVER, 144", TOP INTAKE (specify type of heat)	43CF-144TC-AT
10	TOP COVER, 156", FRONT INTAKE (specify type of heat)	43CF-156TC-AF
10	TOP COVER, 156", TOP INTAKE (specify type of heat)	43CF-156TC-AT
10	TOP COVER, 168", FRONT INTAKE (specify type of heat)	43CF-168TC-AF
10	TOP COVER, 168", TOP INTAKE (specify type of heat)	43CF-168TC-AT
10	TOP COVER, 180", FRONT INTAKE (specify type of heat)	43CF-180TC-AF
10	TOP COVER, 180", TOP INTAKE (specify type of heat)	43CF-180TC-AT
10	TOP COVER, 192", FRONT INTAKE (specify type of heat)	43CF-192TC-AF
10	TOP COVER, 192", TOP INTAKE (specify type of heat)	43CF-192TC-AT
11	ELECTRIC HEAT COILS (length, kW, & voltage required)	Consult Factory
12	STEAM COILS (specify length & connection)	Consult Factory
12	HOT WATER COILS (specify length & connection)	Consult Factory

*** SPECIFY LENGTH (IN INCHES)

** SPECIFY LENGTH (IN INCHES)

SHEET 2 OF 2

PROJECT		
LOCATION		
ARCHITECT		
ENGINEER		REV. -
DWG. NO.	IDC16&20-RP	TITLE: BERNER
DATE	04NOV14	MODEL IDC16/IDC20 AIR CURTAIN
BY	S. Beil	REPLACEMENT PARTS
REPLACES	-	BERNER INTERNATIONAL CORP. NEW CASTLE, PA.
BY	-	