



ARCHITECTURAL RECESSED 16

Electric Heated Air Curtain

Data Sheet

Recommended for Mounting Heights to 16' (environmental separation)

STANDARD CONSTRUCTION

- 15" high x 26" deep
- 1 hp motor(s) - two speeds
- Factory installed Intelliswitch digital controller
- White aluminum bottom panel
- Top Mounting only
- High efficiency, low noise Pro-V Nozzle
- Patented venturi open helical element with point suspension
- Alternate kW: see sheet EP-252
- Filter (washable)

OPTIONS

- Bottom panel finish: Custom Color or Stainless
- Berner AIR™ (smart controller & app, includes BACnet)

2 Year
Limited
Warranty



indoor use



MODEL	Nozzle Width (in)	Max Vel. at Nozzle (fpm)	Avg. Outlet Vel. (fpm)	Air Volume (cfm)	Outlet Vel. Uniformity	Power Rating (kW)	Motor(s) @ hp	Max Electric Capacity (kW)	Heater Output (MBH)	Air Temp. Rise (°F)	Net Wt. (lbs)
ARC16-1036E	36.00	6,250	2,368	2,072	90%	0.91	1 @ 1	14.0	47.8	21°	108
ARC16-1042E	42.00	5,594	2,208	2,254	88%	0.96	1 @ 1	14.0	47.8	20°	115
ARC16-1048E	48.00	5,627	2,015	2,351	77%	1.09	1 @ 1	14.0	47.8	19°	121
ARC16-1060E	66.00	5,401	1,502	2,410	73%	1.12	1 @ 1	14.0	47.8	18°	141
ARC16-2060E	66.00	4,440	2,446	3,924	92%	1.79	2 @ 1	28.0	95.6	22°	185
ARC16-2072E	72.00	6,250	2,368	4,144	90%	1.82	2 @ 1	28.0	95.6	21°	195
ARC16-2084E	84.00	5,594	2,208	4,508	88%	1.92	2 @ 1	28.0	95.6	20°	208
ARC16-2096E	99.00	5,627	1,954	4,702	77%	2.18	2 @ 1	28.0	95.6	19°	219
ARC16-3096E	99.00	6,250	2,492	5,996	90%	2.70	3 @ 1	42.0	143.3	22°	265
ARC16-2108E	108.00	5,401	1,814	4,761	73%	2.21	2 @ 1	28.0	95.6	19°	237
ARC16-3108E	108.00	6,250	2,368	6,216	90%	2.73	3 @ 1	42.0	143.3	21°	293
ARC16-2120E	117.00	5,401	1,695	4,820	73%	2.24	2 @ 1	28.0	95.6	18°	255
ARC16-3120E	117.00	5,594	2,314	6,580	88%	2.83	3 @ 1	42.0	143.3	20°	305
ARC16-3132E	132.00	5,627	2,138	6,859	77%	3.01	3 @ 1	42.0	143.3	19°	317
ARC16-3144E	144.00	5,627	2,015	7,053	77%	3.27	3 @ 1	42.0	143.3	19°	328
ARC16-4144E	144.00	6,250	2,368	8,288	90%	3.64	4 @ 1	56.0	191.1	21°	390

NOTES:

1. Operation at 50 Hz will generate approximately a 17% reduction in air performance.
2. Performance data based on AMCA licensed data from unheated units.
3. Single Point Power Connection – consult factory

Berner does not recommend ARC16-1060E, ARC16-2108E and ARC16-2120E, exists only as an equivalent to competitors' models.

See sheet EP-252 for amp draws/total load requirements and alternate kW.

MODEL NUMBER CONFIGURATION

ARC16-1 036 E B-140 -R-WCA-SS

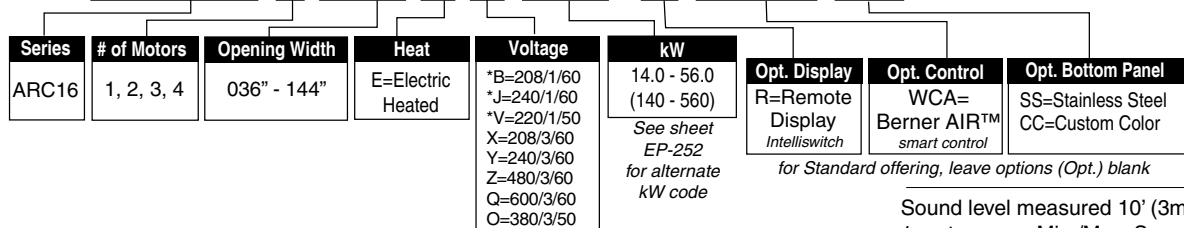

*Max 16kW
See sheet EP-252 for available lengths and voltages

See sheet EP-252 for alternate kW code

for Standard offering, leave options (Opt.) blank

Sound level measured 10' (3m) from the unit in free field:		
1 motor:	Min./Max. Speed:	62/65 dBA
2 motors:	Min./Max. Speed:	65/68 dBA
3 motors:	Min./Max. Speed:	67/70 dBA
4 motors:	Min./Max. Speed:	68/71 dBA

Sound data is not AMCA certified.

Berner reserves the right to alter specifications without prior notice.



ARCHITECTURAL RECESSED 16

Electric Heated Air Curtain

Electrical Performance Sheet

MODEL	kW (suffix)	Temp Rise °F	208/1/60 (voltage code B) MOTOR AMP DRAW = 6.5 each			240/1/60 (voltage code J) or 220/1/50 (voltage code V) MOTOR AMP DRAW = 6.5 each			208/3/60 (voltage code X) MOTOR AMP DRAW = 6.5 each			240/3/60 (voltage code Y) MOTOR AMP DRAW = 6.5 each		
			# CKTS	AMPS PER CIRCUIT (including motor)	BREAKER RATING PER CIRCUIT	# CKTS	AMPS PER CIRCUIT (including motor)	BREAKER RATING PER CIRCUIT	# CKTS	AMPS PER CIRCUIT (including motor)	BREAKER RATING PER CIRCUIT	# CKTS	AMPS PER CIRCUIT (including motor)	BREAKER RATING PER CIRCUIT
ARC16-1036E ARC16-1042E ARC16-1048E ARC16-1060E	14 (140)	20	2	29.0/44.9	40/60	2	26.0/38.9	35/50	1	45.4	60	1	40.2	60
	10 (100)	14	2	22.5/32.0	30/40	1	48.2	60	1	34.3	45	1	30.6	40
	8 (080)	11	1	45.0	60	1	39.8	50	1	28.7	40	1	25.7	35
	6 (060)	8	1	35.3	45	1	31.5	40	1	23.2	30	1	20.9	30
ARC16-2060E ARC16-2072E ARC16-2084E ARC16-2096E ARC16-2108E ARC16-2120E	28 (280)	20	-	N/A	N/A	-	N/A	N/A	2	51.9/38.9	60/50	2	46.7/33.7	60/45
	20 (200)	14	-	N/A	N/A	-	N/A	N/A	2	40.8/27.8	50/35	2	37.1/24.1	45/35
	16 (160)	11	2	51.5/38.5	60/50	2	46.3/33.3	60/45	2	35.2/22.2	45/30	1	51.5	60
	12 (120)	8	2	41.8/28.8	60/40	2	38.0/25.0	50/35	1	46.3	60	1	41.9	60
ARC16-3096E ARC16-3108E ARC16-3120E ARC16-3132E ARC16-3144E	42 (420)	20	-	N/A	N/A	-	N/A	N/A	3	45.4/45.4/45.4	60/60/60	3	46.7/40.2/33.7	60/60/45
	30 (300)	14	-	N/A	N/A	-	N/A	N/A	3	47.3/27.8/27.8	60/35/35	2	43.6/48.1	60/60
	24 (240)	11	-	N/A	N/A	-	N/A	N/A	2	41.7/44.4	50/60	2	38.7/38.5	50/50
	18 (180)	8	-	N/A	N/A	-	N/A	N/A	2	36.2/33.3	45/45	2	33.9/28.9	40/40
ARC16-4144E	56 (560)	20	-	N/A	N/A	-	N/A	N/A	4	51.9/38.9/51.9/38.9	60/50/60/50	4	46.7/33.7/46.7/33.7	60/45/60/45
	40 (400)	14	-	N/A	N/A	-	N/A	N/A	4	40.8/27.8/40.8/27.8	50/35/50/35	3	50.1/24.1/48.1	60/35/60
	32 (320)	11	-	N/A	N/A	-	N/A	N/A	3	35.2/35.2/44.4	45/45/60	2	51.5/51.5	60/60
	24 (240)	8	-	N/A	N/A	-	N/A	N/A	2	46.3/46.3	60/60	2	41.9/41.9	60/60



ARCHITECTURAL RECESSED 16

**Electric Heated Air Curtain
Electrical Performance Sheet**

MODEL	kW (suffix)	Temp Rise °F	480/3/60 (voltage code Z) MOTOR AMP DRAW = 3.2 each			600/3/60 (voltage code Q) MOTOR AMP DRAW = 2.0 each			380/3/50 (voltage code O) MOTOR AMP DRAW = 6.5 each		
			# CKTS	AMPS PER CIRCUIT (including motor)	BREAKER RATING PER CIRCUIT	# CKTS	AMPS PER CIRCUIT (including motor)	BREAKER RATING PER CIRCUIT	# CKTS	AMPS PER CIRCUIT (including motor)	BREAKER RATING PER CIRCUIT
ARC16-1036E ARC16-1042E ARC16-1048E ARC16-1060E	14 (140)	20	1	20.0	25	1	15.5	20	1	27.8	35
	10 (100)	14	1	15.2	20	1	11.6	15	1	21.7	30
	8 (080)	11	1	12.8	20	1	9.7	15	1	18.7	25
	6 (060)	8	1	10.4	15	1	7.8	15	1	15.6	20
ARC16-2060E ARC16-2072E ARC16-2084E ARC16-2096E ARC16-2108E ARC16-2120E	28 (280)	20	1	40.1	50	1	30.9	40	2	34.3/21.3	45/30
	20 (200)	14	1	30.5	40	1	23.2	30	1	43.4	60
	16 (160)	11	1	25.6	35	1	19.4	25	1	37.3	50
	12 (120)	8	1	20.8	30	1	15.5	20	1	31.2	40
ARC16-3096E ARC16-3108E ARC16-3120E ARC16-3132E ARC16-3144E	42 (420)	20	2	26.4/33.7	35/45	1	46.4	60	2	40.8/42.5	50/60
	30 (300)	14	1	45.7	60	1	34.9	45	2	34.7/30.4	45/40
	24 (240)	11	1	38.5	50	1	29.1	40	2	43.8/12.2	60/20
	18 (180)	8	1	31.3	40	1	23.3	30	1	46.8	60
ARC16-4144E	56 (560)	20	2	46.5/33.7	60/45	2	34.9/26.9	45/40	3	47.3/42.5/21.3	60/60/30
	40 (400)	14	2	36.9/24.1	45/35	1	46.5	60	2	41.2/45.6	50/60
	32 (320)	11	1	51.3	60	1	38.8	50	2	38.2/36.5	45/50
	24 (240)	8	1	41.7	50	1	31.1	40	2	44.2/18.2	60/25

ARC16 IN-CEILING MOUNT ELECTRIC HEATED

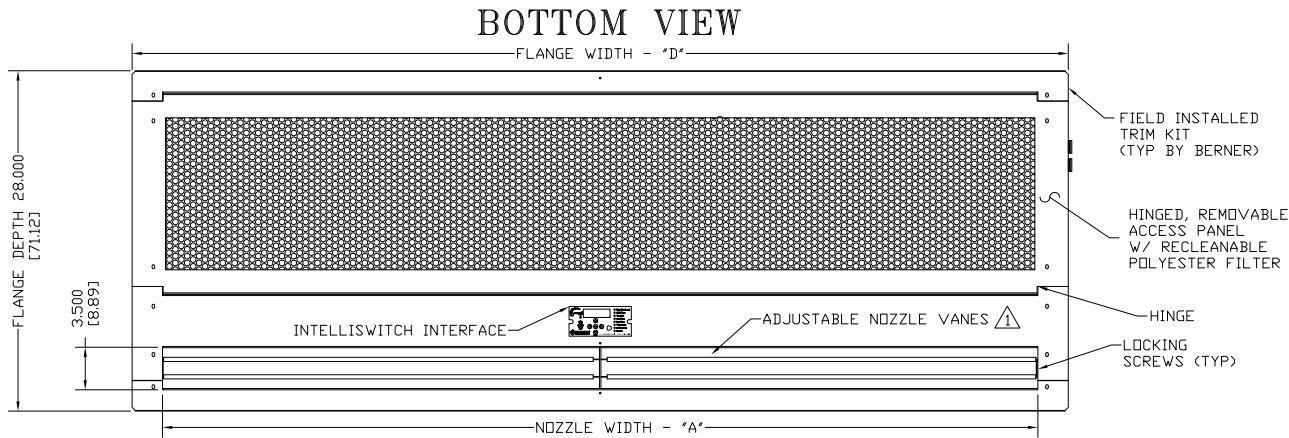
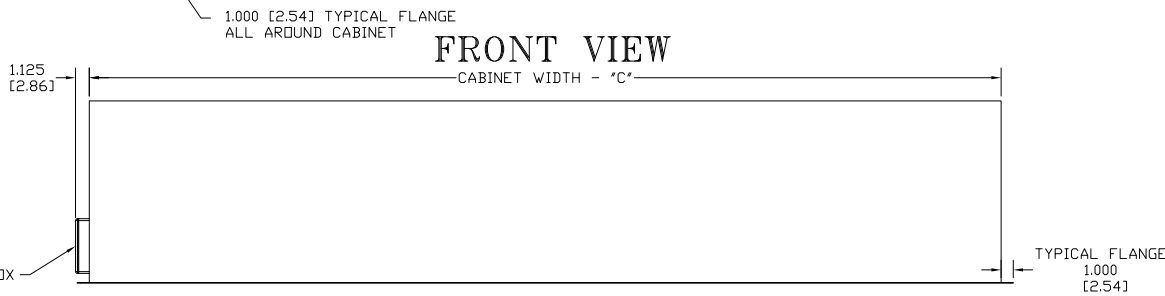
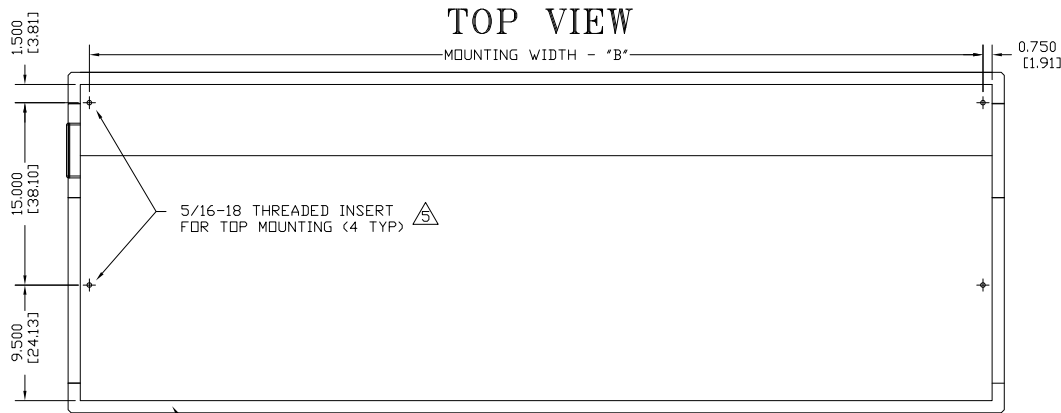

END VIEW

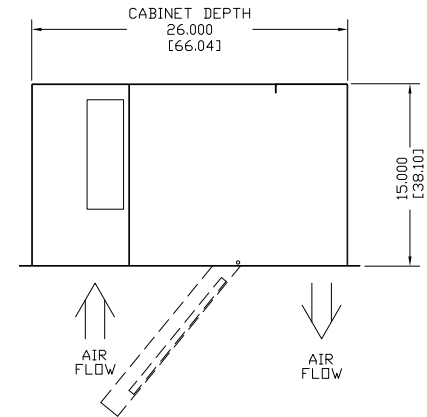

NOTES:

- ① AIR CURTAIN MUST BE INSTALLED SO AIR STREAM IS NOT OBSTRUCTED WHEN DEFLECTED 20° TO EITHER SIDE OF C.
- ② ELECTRICAL CONNECTIONS TO BE FLEXIBLE.
- ③ FIELD VERIFY DIMENSIONS.
- ④ ANCHORS TO SUPPORTING STRUCTURE BY OTHERS.
- ⑤ ADEQUACY OF SUPPORTING STRUCTURE IS TO BE VERIFIED BY A PROFESSIONAL STRUCTURAL ENGINEER.
- ⑥ LETTER "E" IN MODEL NUMBER DESIGNATES ELECTRIC HEATED UNIT.
- ⚠ DIMENSIONS IN INCHES [CENTIMETERS].

MODEL ⚠	NOZZLE WIDTH "A"	MOUNTING WIDTH "B"	CABINET WIDTH "C"	FLANGE WIDTH "D"	RECOMMENDED ROUGH OPENING DEPTH x WIDTH
ARC16-1036E	36.00 [91.44]	37.50 [95.25]	39.00 [99.06]	41.00 [104.14]	27.00 x 40.00 [68.58 x 101.60]
ARC16-1042E	42.00 [106.68]	43.50 [110.49]	45.00 [114.30]	47.00 [119.38]	27.00 x 46.00 [68.58 x 116.84]
ARC16-1048E	48.00 [121.92]	49.50 [125.73]	51.00 [129.54]	53.00 [134.62]	27.00 x 52.00 [68.58 x 132.08]
ARC16-1060E/2060E	66.00 [167.64]	67.50 [171.45]	69.00 [175.26]	71.00 [180.34]	27.00 x 70.00 [68.58 x 177.80]
ARC16-2072E	72.00 [182.88]	73.50 [186.69]	75.00 [190.50]	77.00 [195.58]	27.00 x 76.00 [68.58 x 193.04]
ARC16-2084E	84.00 [213.36]	85.50 [217.17]	87.00 [220.98]	89.00 [226.06]	27.00 x 88.00 [68.58 x 223.52]
ARC16-2096E/3096E	99.00 [251.46]	100.50 [255.27]	102.00 [259.08]	104.00 [264.16]	27.00 x 103.00 [68.58 x 261.62]
ARC16-2108E/3108E	108.00 [274.32]	109.50 [278.13]	111.00 [281.94]	113.00 [287.02]	27.00 x 112.00 [68.58 x 284.48]
ARC16-2120E/3120E	117.00 [297.18]	118.50 [300.99]	120.00 [304.80]	122.00 [309.88]	27.00 x 121.00 [68.58 x 307.34]
ARC16-3132E	132.00 [335.28]	133.50 [339.09]	135.00 [342.90]	137.00 [347.98]	27.00 x 136.00 [68.58 x 345.44]
ARC16-3144E/4144E	144.00 [365.76]	145.50 [369.57]	147.00 [373.38]	149.00 [378.46]	27.00 x 148.00 [68.58 x 375.92]

PROJECT		
LOCATION		
ARCHITECT		
ENGINEER		REV. --
DWG. NO.	ARC16-ELE	TITLE: BERNER
DATE	22SEPT14	MODEL ARC16 AIR CURTAIN
BY	S. Beil	ELECTRIC HEATED SYSTEM
REPLACES	-	BERNER INTERNATIONAL CORP. NEW CASTLE, PA.
BY	-	