



HAZARDOUS LOCATION SERIES 20

Hot Water Heated Air Curtain

Data Sheet

For Door Heights To 20' (environmental separation)

STANDARD CONSTRUCTION

- Constructed for Class I, Division 1 & 2, Groups C & D
- Explosion proof single speed motor(s) temperature code T3C
- Interior and exterior gray zinc epoxy powder coated aluminized steel cabinet and screen
- Split cabinet construction for fan assembly removal
- External mount explosion proof junction box (One per motor)
- Aluminum impellers in zinc epoxy powder coated galvanized steel housing
- ABS plastic air diverters, factory assembled to the outlet of each blower housing
- Top Mounting only
- High efficiency Pro-V Nozzle

Coil Features:

- Aluminum casing
- 5/8" copper tube with .035" wall
- Aluminum fins
- Leak tested at 450 psi

NOTES:

- NO VERTICAL MOUNTING
- For construction other than standard, Consult Factory

2 Year
Limited
Warranty



MODEL	Nozzle Width (in)	Max Vel. at Nozzle (fpm)	Avg. Outlet Vel. (fpm)	Air Volume (cfm)	Outlet Vel. Uniformity	Power Rating (kW)	Motor(s) @ hp	Coil Output (MBH)	Entering / Leaving Water Temp. (°F)	Water Flow (GPM)	Fluid Pressure Drop (FT. WG.)	Air Temp. Rise (°F)	Net Wt. (lbs)
HLC20-1060W	60.00	6,580	4,181	7,403	89%	4.70	1 @ 5	267.3	180° / 158°	25.0	2.4	33°	529
HLC20-1072W	72.00	6,549	3,852	8,186	89%	4.90	1 @ 5	311.3	180° / 158°	29.0	3.3	35°	587
HLC20-1084W	84.00	6,076	3,574	8,861	87%	4.90	1 @ 5	352.5	180° / 158°	33.0	4.4	36°	645
HLC20-1096W	96.00	6,900	4,059	11,500	92%	6.80	1 @ 7½	439.0	180° / 158°	41.0	6.9	35°	937
HLC20-1108W	108.00	6,747	3,969	12,650	90%	6.90	1 @ 7½	491.7	180° / 158°	46.0	8.8	36°	1,030
HLC20-1120W	117.00	7,494	4,523	15,612	88%	8.70	1 @ 10	576.1	180° / 158°	53.0	11.8	34°	1,110
HLC20-1132W	132.00	7,017	4,127	16,080	87%	8.90	1 @ 10	616.6	180° / 157°	55.0	13.1	35°	1,174
HLC20-1144W	144.00	7,640	4,381	19,100	87%	11.70	1 @ 15	707.9	180° / 157°	62.0	16.8	34°	1,227
HLC20-1156W	156.00	7,405	4,356	20,055	86%	11.90	1 @ 15	749.4	180° / 156°	63.0	17.7	34°	1,345
HLC20-1168W	168.00	7,783	4,323	22,700	90%	12.80	1 @ 15	831.6	180° / 155°	69.0	21.5	33°	1,443
HLC20-1180W	180.00	7,300	4,294	22,814	91%	12.90	1 @ 15	855.8	180° / 155°	69.0	21.9	34°	1,504
HLC20-2192W	192.00	6,900	4,059	23,000	92%	13.60	2 @ 7½	880.1	180° / 154°	69.0	22.3	35°	1,837

NOTES:

- Performance data based on AMCA licensed data from unheated IDC20 units.
- Coil performance based on 65°F entering air temperature.
- Standard connection same end supply/return (Optional: opposite end supply/return).
- Coil should be field supplied with a solenoid valve that energizes only when air curtain is energized. Consideration must be taken for freeze protection when necessary.
- Maximum leaving air temperature shall not exceed 120°F.
- Consult factory for 50 Hz operation, alternate entering air & water temperatures, GPM's, and opposite end supply/return connections performance data.
- Vertically mounted Hazardous Location Series air curtains not available.

See sheet EP-936 for amp draws/total load requirements.

MODEL NUMBER CONFIGURATION

HLC20-1 060 W D-F

Series	# of Motors	Opening Width	Heat	Voltage	Intake
HLC20	1, 2	060" - 192"	W=Hot Water Heated	D=208/3/60 E=240/3/60 H=480/3/60 I=600/3/60	T=Top F=Front

Sound level measured 10' (3m) from the unit in free field:
5, 7½, 10, 15 & (7½ + 7½) hp motor(s):
73 dBA, 75 dBA, 76 dBA, 78 dBA & 78 dBA

Berner reserves the right to alter specifications without prior notice.

www.berner.com Berner International 800.245-4455
111 Progress Ave. / New Castle / PA / 16101 / USA

DS-936
January, 2024

©Copyright, 2024 Berner International



HAZARDOUS LOCATION SERIES 20

Hot Water Heated Air Curtain

Electrical Performance Sheet

MODEL	Qty @ HP	# CKTS	208/3/60 (voltage code D) TOTAL MOTOR AMP DRAW		# CKTS	240/3/60 (voltage code E) TOTAL MOTOR AMP DRAW		# CKTS	480/3/60 (voltage code H) TOTAL MOTOR AMP DRAW		# CKTS	600/3/60 (voltage code I) TOTAL MOTOR AMP DRAW	
			AMPS PER CIRCUIT	BREAKER RATING PER CIRCUIT		AMPS PER CIRCUIT	BREAKER RATING PER CIRCUIT		AMPS PER CIRCUIT	BREAKER RATING PER CIRCUIT		AMPS PER CIRCUIT	BREAKER RATING PER CIRCUIT
HLC20-1060W HLC20-1072W HLC20-1084W	1 @ 5	1	17.0	35	1	15.8	35	1	7.9	20	1	5.9	15
HLC20-1096W HLC20-1108W	1 @ 7.5	1	23.0	50	1	21.4	45	1	10.7	25	1	8.5	20
HLC20-1120W HLC20-1132W	1 @ 10	1	31.2	70	1	31.0	70	1	15.5	35	1	12.0	25
HLC20-1144W HLC20-1156W HLC20-1168W HLC20-1180W	1 @ 15	1	42.0	100	1	42.0	100	1	21.0	45	1	16.0	35
HLC20-2192W	2 @ 7.5	1	46.0	70	1	42.8	70	1	21.4	35	1	17.0	30

Berner reserves the right to alter specifications without prior notice.

www.berner.com **Berner International** 800.245-4455
111 Progress Ave. / New Castle / PA / 16101 / USA

EP-936
May, 2023

©Copyright, 2023 Berner International

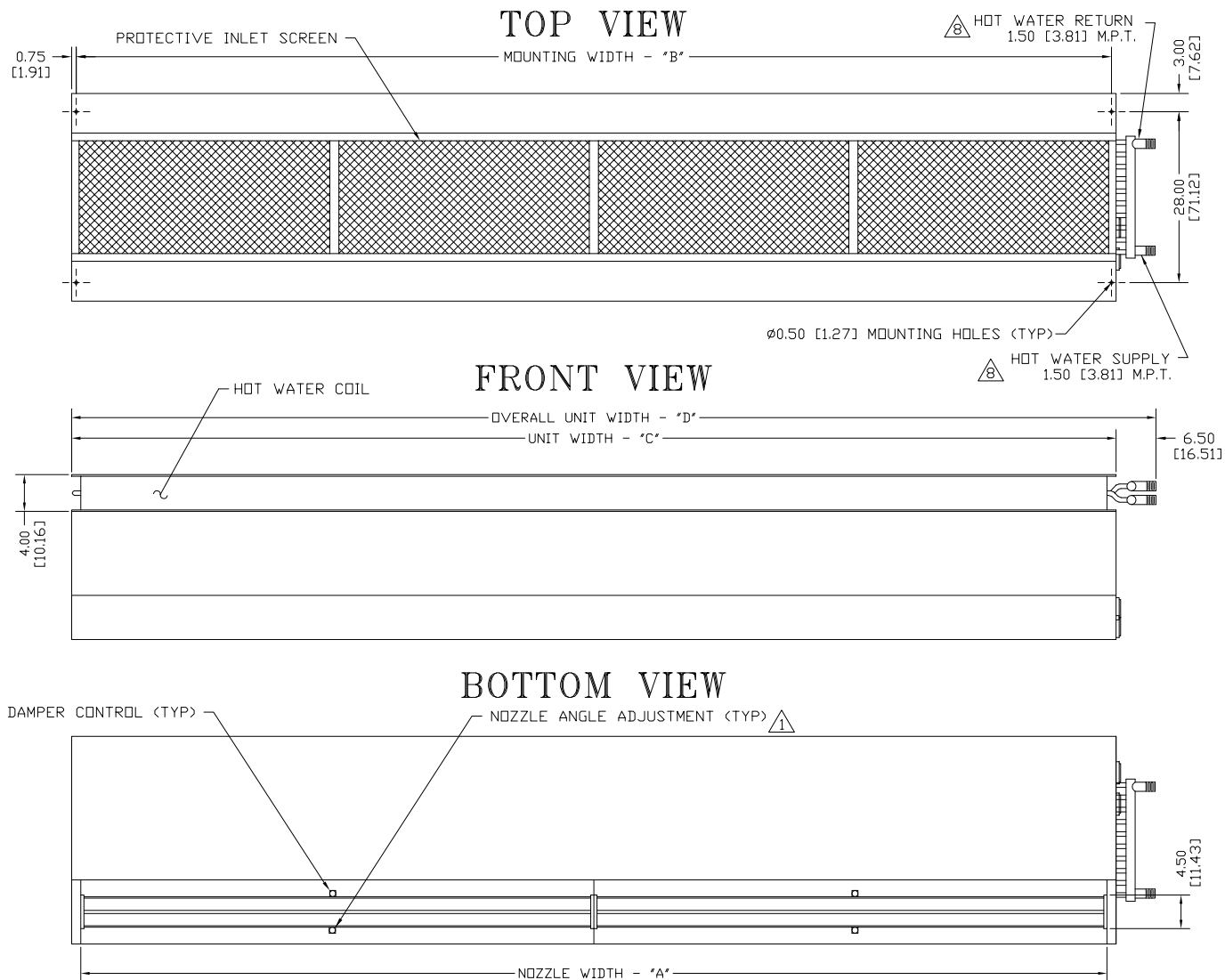

HLC20

HOT WATER HEATED TOP INTAKE SAME END SUP./RET. HAZARDOUS LOCATION

END VIEW

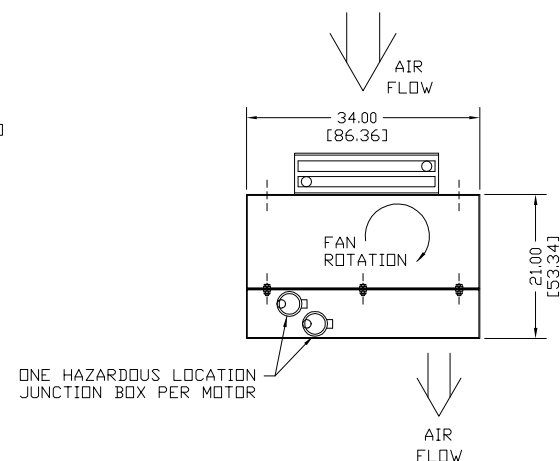

NOTES:

- ⚠ AIR CURTAIN MUST BE INSTALLED SO AIR STREAM IS NOT OBSTRUCTED WHEN DEFLECTED 20° TO EITHER SIDE OF C.
- ⚠ ELECTRICAL CONNECTIONS TO BE FLEXIBLE.
- ⚠ FIELD VERIFY DIMENSIONS.
- ⚠ ANCHORS TO SUPPORTING STRUCTURE BY OTHERS.
- ⚠ ADEQUACY OF SUPPORTING STRUCTURE IS TO BE VERIFIED BY A PROFESSIONAL STRUCTURAL ENGINEER.
- ⚠ LETTER "W" IN MODEL NUMBER DESIGNATES HOT WATER HEATED UNIT, THE "T" IS FOR TOP INTAKE.
- ⚠ REMOTE OPTIONAL CONTROL PANEL AVAILABLE; NEMA 4/12 FOR NON HAZARDOUS LOCATION MOUNTING; NEMA 7/9 FOR HAZARDOUS LOCATION MOUNTING. PLEASE SPECIFY.
- ⚠ COIL CONNECTIONS AS SHOWN, OPPOSITE AND SAME END CONNECTIONS AVAILABLE, PLEASE SPECIFY.
- ⚠ DIMENSIONS IN INCHES [CENTIMETERS].

MODEL ⚠	NOZZLE WIDTH "A"	MOUNTING WIDTH "B"	UNIT WIDTH "C"	OVERALL WIDTH "D"
HLC20-1060W-T	60.00 [152.40]	61.50 [156.21]	63.00 [160.02]	69.50 [176.53]
HLC20-1072W-T	72.00 [182.88]	73.50 [186.69]	75.00 [190.50]	81.50 [207.01]
HLC20-1084W-T	84.00 [213.36]	85.50 [217.17]	87.00 [220.98]	93.50 [237.49]
HLC20-1096W-T	96.00 [243.84]	97.50 [247.65]	99.00 [251.46]	105.50 [267.97]
HLC20-1108W-T	108.00 [274.32]	109.50 [278.13]	111.00 [281.94]	117.50 [298.45]
HLC20-1120W-T	117.00 [297.18]	118.50 [300.99]	120.00 [304.80]	126.50 [321.31]
HLC20-1132W-T	132.00 [335.28]	133.50 [339.09]	135.00 [342.90]	141.50 [359.41]
HLC20-1144W-T	144.00 [365.76]	145.50 [369.57]	147.00 [373.38]	153.50 [389.89]
HLC20-1156W-T	156.00 [396.24]	157.50 [400.05]	159.00 [403.86]	165.50 [420.37]
HLC20-1168W-T	168.00 [426.72]	169.50 [430.53]	171.00 [434.34]	177.50 [450.85]
HLC20-1180W-T	180.00 [457.20]	181.50 [461.01]	183.00 [464.82]	189.50 [481.33]
HLC20-2192W-T	192.00 [487.68]	193.50 [491.49]	195.00 [495.30]	201.50 [511.81]

PROJECT		
LOCATION		
ARCHITECT		
ENGINEER		
DWG. NO.	HLC20-WTR1	TITLE: BERNER
DATE	18JUNE14	MODEL HLC20 AIR CURTAIN
BY	S. Beil	HAZARDOUS LOCATION TOP INTAKE HOT WATER HEATED SYSTEM
REPLACES	-	
BY	-	BERNER INTERNATIONAL CORP. NEW CASTLE, PA.

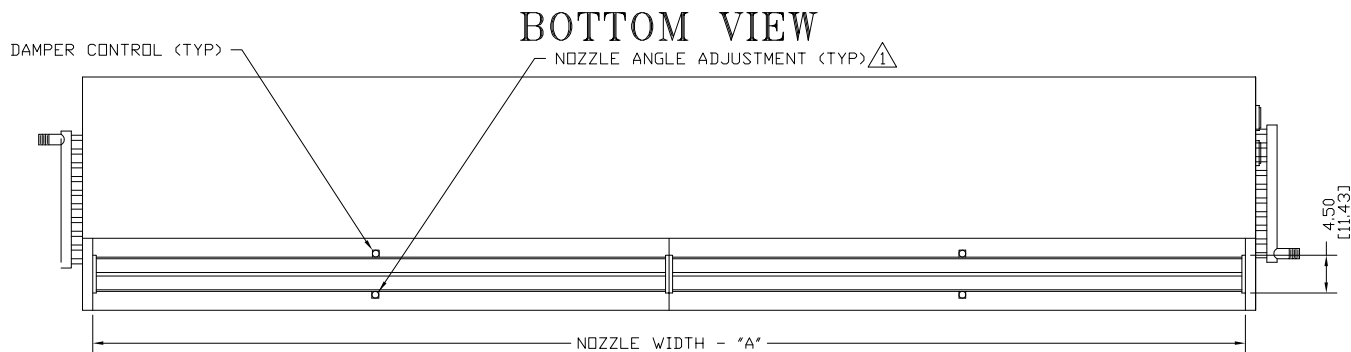
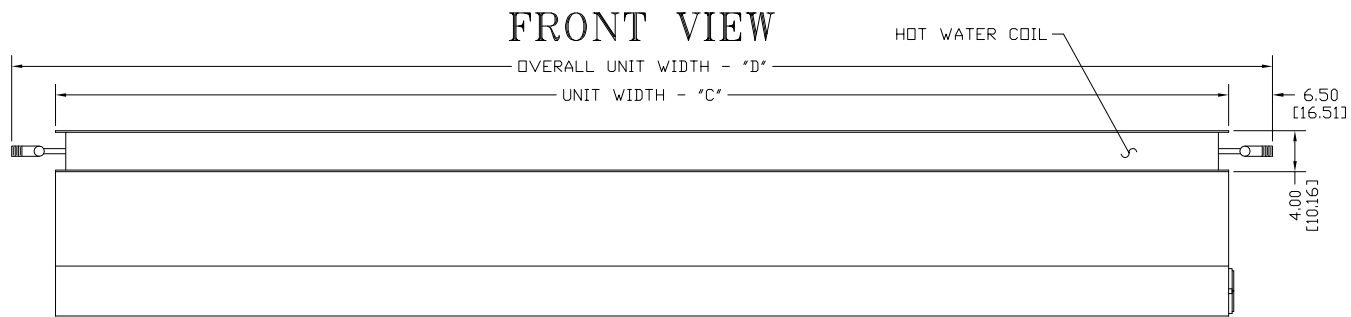
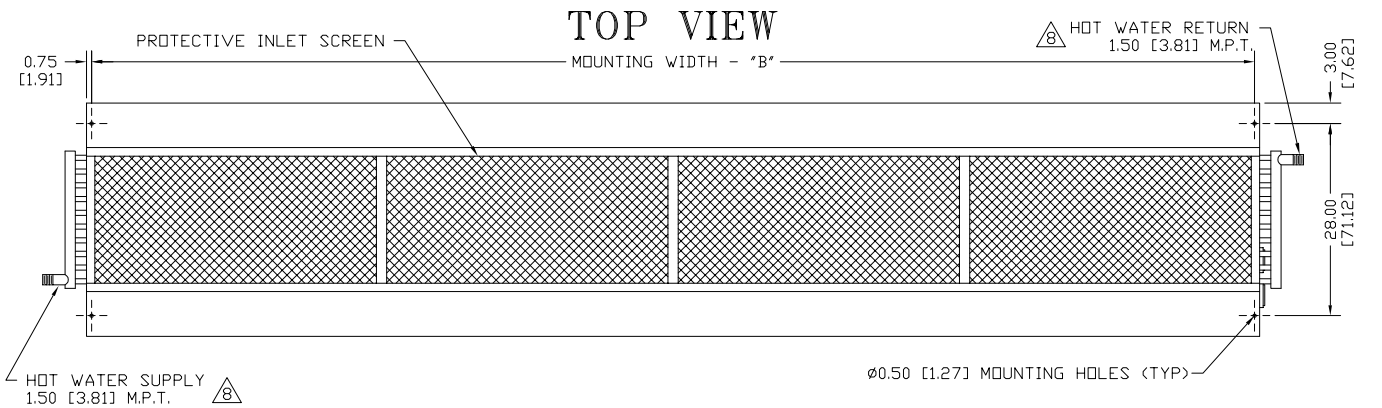

MODEL	NOZZLE WIDTH "A"	MOUNTING WIDTH "B"	UNIT WIDTH "C"	OVERALL WIDTH "D"
HLC20-1060W-T	60.00 [152.40]	61.50 [156.21]	63.00 [160.02]	76.00 [193.04]
HLC20-1072W-T	72.00 [182.88]	73.50 [186.69]	75.00 [190.50]	88.00 [223.52]
HLC20-1084W-T	84.00 [213.36]	85.50 [217.17]	87.00 [220.98]	100.00 [254.00]
HLC20-1096W-T	96.00 [243.84]	97.50 [247.65]	99.00 [251.46]	112.00 [284.48]
HLC20-1108W-T	108.00 [274.32]	109.50 [278.13]	111.00 [281.94]	124.00 [314.96]
HLC20-1120W-T	117.00 [297.18]	118.50 [300.99]	120.00 [304.80]	133.00 [337.82]
HLC20-1132W-T	132.00 [335.28]	133.50 [339.09]	135.00 [342.90]	148.00 [375.92]
HLC20-1144W-T	144.00 [365.76]	145.50 [369.57]	147.00 [373.38]	160.00 [406.40]
HLC20-1156W-T	156.00 [396.24]	157.50 [400.05]	159.00 [403.86]	172.00 [436.88]
HLC20-1168W-T	168.00 [426.72]	169.50 [430.53]	171.00 [434.34]	184.00 [467.36]
HLC20-1180W-T	180.00 [457.20]	181.50 [461.01]	183.00 [464.82]	196.00 [497.84]
HLC20-2192W-T	192.00 [487.68]	193.50 [491.49]	195.00 [495.30]	208.00 [528.32]

HLC20

HOT WATER HEATED TOP INTAKE OPP. END SUP./RET. HAZARDOUS LOCATION

END VIEW

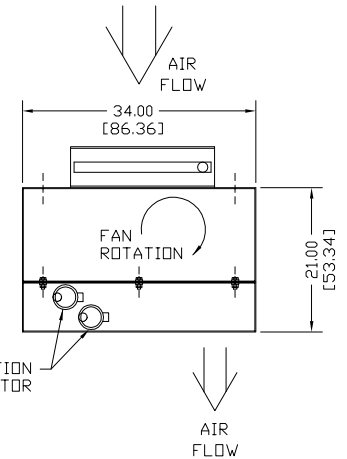

ONE HAZARDOUS LOCATION
JUNCTION BOX PER MOTOR

NOTES:

- ⚠ AIR CURTAIN MUST BE INSTALLED SO AIR STREAM IS NOT OBSTRUCTED WHEN DEFLECTED 20° TO EITHER SIDE OF C.
- ⚠ ELECTRICAL CONNECTIONS TO BE FLEXIBLE.
- ⚠ FIELD VERIFY DIMENSIONS.
- ⚠ ANCHORS TO SUPPORTING STRUCTURE BY OTHERS.
- ⚠ ADEQUACY OF SUPPORTING STRUCTURE IS TO BE VERIFIED BY A PROFESSIONAL STRUCTURAL ENGINEER.
- ⚠ LETTER "W" IN MODEL NUMBER DESIGNATES HOT WATER HEATED UNIT, THE "T" IS FOR TOP INTAKE.
- ⚠ REMOTE OPTIONAL CONTROL PANEL AVAILABLE; NEMA 4/12 FOR NON HAZARDOUS LOCATION MOUNTING; NEMA 7/9 FOR HAZARDOUS LOCATION MOUNTING. PLEASE SPECIFY.
- ⚠ COIL CONNECTIONS AS SHOWN, OPPOSITE AND SAME END CONNECTIONS AVAILABLE, PLEASE SPECIFY.
- ⚠ DIMENSIONS IN INCHES [CENTIMETERS].

PROJECT		TITLE:	BERNER
LOCATION			MODEL HLC20 AIR CURTAIN
ARCHITECT			HAZARDOUS LOCATION TOP INTAKE HOT WATER HEATED SYSTEM
ENGINEER			
DWG. NO.	HLC20-WTR2	DATE	18JUNE14
BY	S. Beil	REPLACES	-
		BY	-
			BERNER INTERNATIONAL CORP. NEW CASTLE, PA.

TOP VIEW

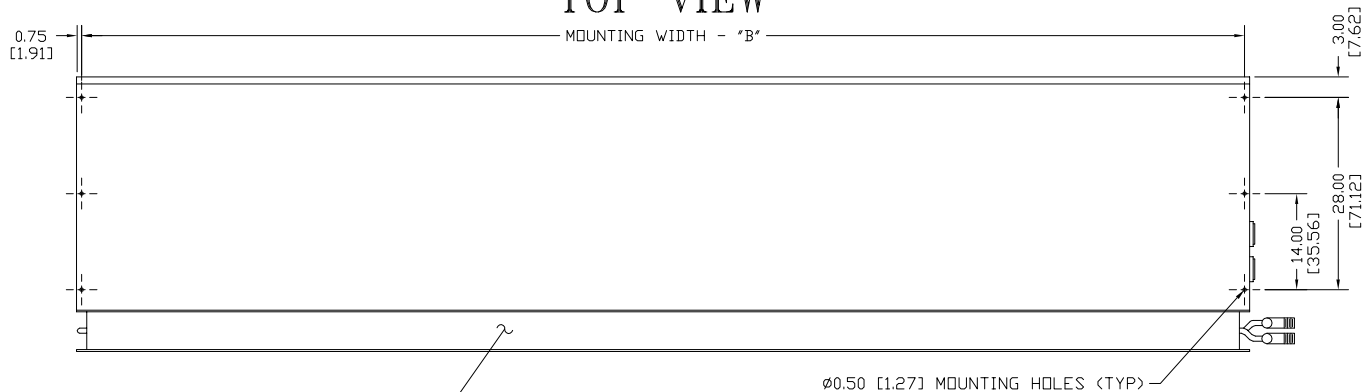

FRONT VIEW

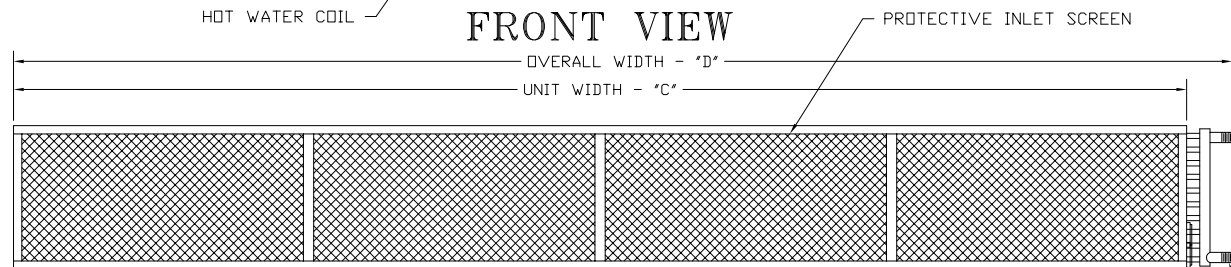

BOTTOM VIEW

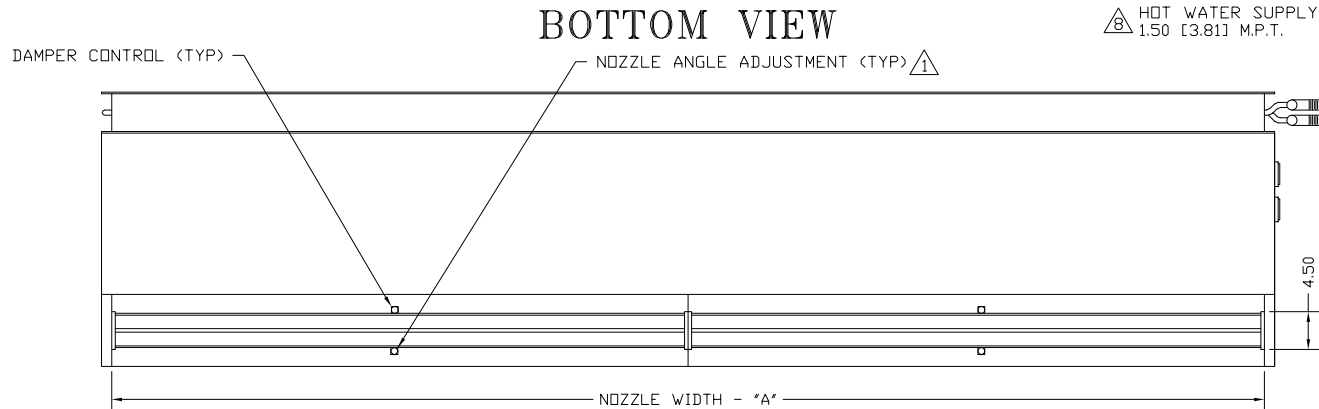

HLC20

HOT WATER HEATED FRONT INTAKE SAME END SUP./RET. HAZARDOUS LOCATION

END VIEW

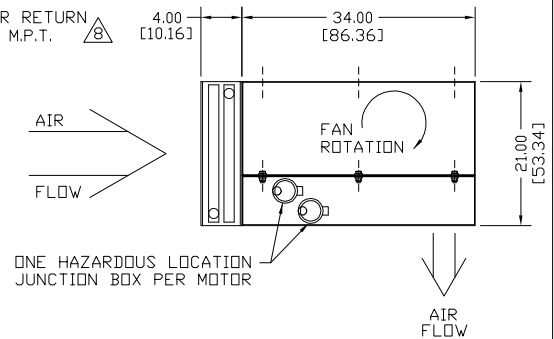

NOTES:

- ⚠ AIR CURTAIN MUST BE INSTALLED SO AIR STREAM IS NOT OBSTRUCTED WHEN DEFLECTED 20° TO EITHER SIDE OF C.
- ⚠ ELECTRICAL CONNECTIONS TO BE FLEXIBLE.
- ⚠ FIELD VERIFY DIMENSIONS.
- ⚠ ANCHORS TO SUPPORTING STRUCTURE BY OTHERS.
- ⚠ ADEQUACY OF SUPPORTING STRUCTURE IS TO BE VERIFIED BY A PROFESSIONAL STRUCTURAL ENGINEER.
- ⚠ LETTER "W" IN MODEL NUMBER DESIGNATES HOT WATER HEATED UNIT, THE "F" IS FOR FRONT INTAKE.
- ⚠ REMOTE OPTIONAL CONTROL PANEL AVAILABLE: NEMA 4/12 FOR NON HAZARDOUS LOCATION MOUNTING; NEMA 7/9 FOR HAZARDOUS LOCATION MOUNTING. PLEASE SPECIFY.
- ⚠ COIL CONNECTIONS AS SHOWN, OPPOSITE AND SAME END CONNECTIONS AVAILABLE, PLEASE SPECIFY.
- ⚠ DIMENSIONS IN INCHES [CENTIMETERS].

MODEL ⚠	NOZZLE WIDTH "A"	MOUNTING WIDTH "B"	UNIT WIDTH "C"	OVERALL WIDTH "D"
HLC20-1060W-F	60.00 [152.40]	61.50 [156.21]	63.00 [160.02]	69.50 [176.53]
HLC20-1072W-F	72.00 [182.88]	73.50 [186.69]	75.00 [190.50]	81.50 [207.01]
HLC20-1084W-F	84.00 [213.36]	85.50 [217.17]	87.00 [220.98]	93.50 [237.49]
HLC20-1096W-F	96.00 [243.84]	97.50 [247.65]	99.00 [251.46]	105.50 [267.97]
HLC20-1108W-F	108.00 [274.32]	109.50 [278.13]	111.00 [281.94]	117.50 [298.45]
HLC20-1120W-F	117.00 [297.18]	118.50 [300.99]	120.00 [304.80]	126.50 [321.31]
HLC20-1132W-F	132.00 [335.28]	133.50 [339.09]	135.00 [342.90]	141.50 [359.41]
HLC20-1144W-F	144.00 [365.76]	145.50 [369.57]	147.00 [373.38]	153.50 [389.89]
HLC20-1156W-F	156.00 [396.24]	157.50 [400.05]	159.00 [403.86]	165.50 [420.37]
HLC20-1168W-F	168.00 [426.72]	169.50 [430.53]	171.00 [434.34]	177.50 [450.85]
HLC20-1180W-F	180.00 [457.20]	181.50 [461.01]	183.00 [464.82]	189.50 [481.33]
HLC20-2192W-F	192.00 [487.68]	193.50 [491.49]	195.00 [495.30]	201.50 [511.81]

PROJECT		
LOCATION		
ARCHITECT		
ENGINEER		
DWG. NO.	HLC20-WTR3	TITLE: BERNER
DATE	18JUNE14	MODEL HLC20 AIR CURTAIN
BY	S. Beil	HAZARDOUS LOCATION FRONT INTAKE HOT WATER HEATED SYSTEM
REPLACES	—	BERNER INTERNATIONAL CORP. NEW CASTLE, PA.
BY	—	

TOP VIEW

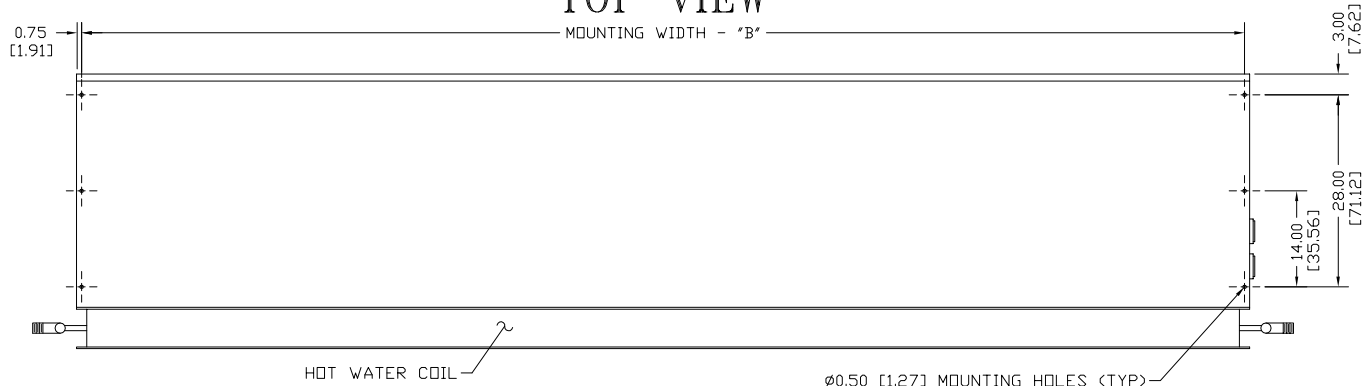

FRONT VIEW

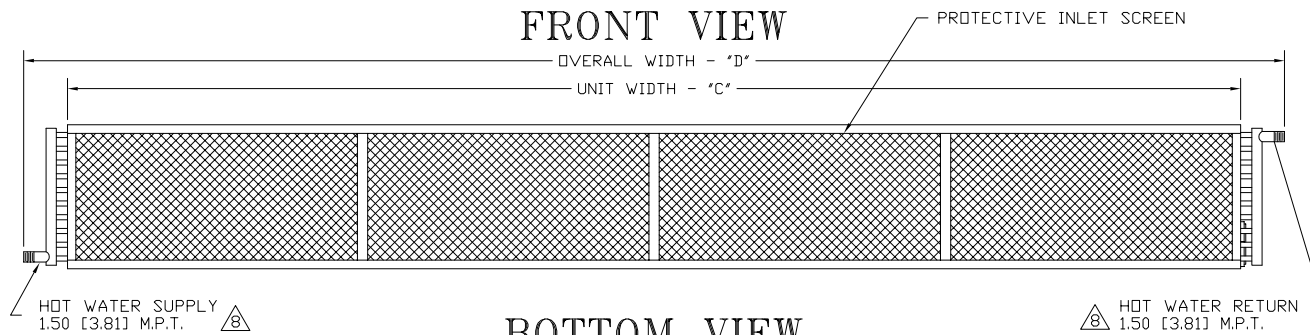

BOTTOM VIEW

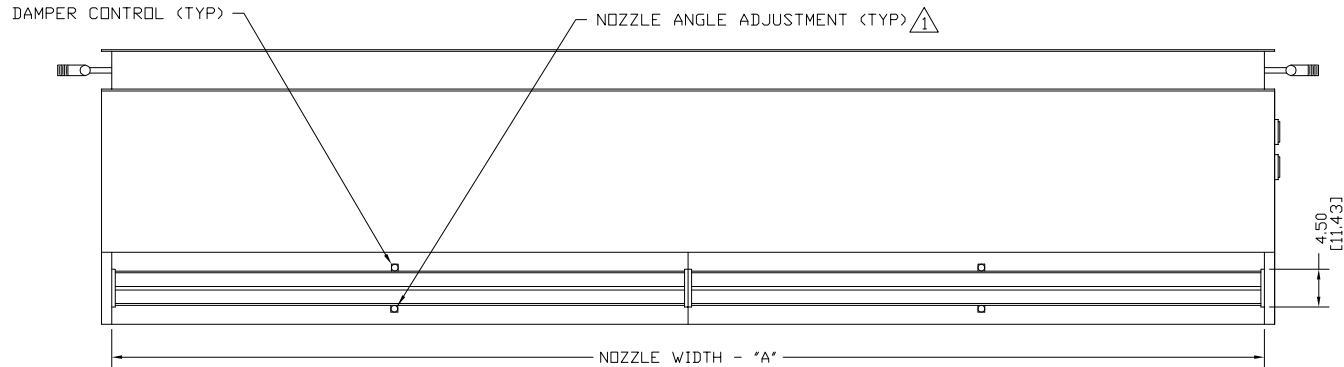

MODEL 	NOZZLE WIDTH "A"	MOUNTING WIDTH "B"	UNIT WIDTH "C"	OVERALL WIDTH "D"
HLC20-1060W-F	60.00 [152.40]	61.50 [156.21]	63.00 [160.02]	76.00 [193.04]
HLC20-1072W-F	72.00 [182.88]	73.50 [186.69]	75.00 [190.50]	88.00 [223.52]
HLC20-1084W-F	84.00 [213.36]	85.50 [217.17]	87.00 [220.98]	100.00 [254.00]
HLC20-1096W-F	96.00 [243.84]	97.50 [247.65]	99.00 [251.46]	112.00 [284.48]
HLC20-1108W-F	108.00 [274.32]	109.50 [278.13]	111.00 [281.94]	124.00 [314.96]
HLC20-1120W-F	117.00 [297.18]	118.50 [300.99]	120.00 [304.80]	133.00 [337.82]
HLC20-1132W-F	132.00 [335.28]	133.50 [339.09]	135.00 [342.90]	148.00 [375.92]
HLC20-1144W-F	144.00 [365.76]	145.50 [369.57]	147.00 [373.38]	160.00 [406.40]
HLC20-1156W-F	156.00 [396.24]	157.50 [400.05]	159.00 [403.86]	172.00 [436.88]
HLC20-1168W-F	168.00 [426.72]	169.50 [430.53]	171.00 [434.34]	184.00 [467.36]
HLC20-1180W-F	180.00 [457.20]	181.50 [461.01]	183.00 [464.82]	196.00 [497.84]
HL-20-2192W-F	192.00 [487.68]	193.50 [491.49]	195.00 [495.30]	208.00 [528.32]



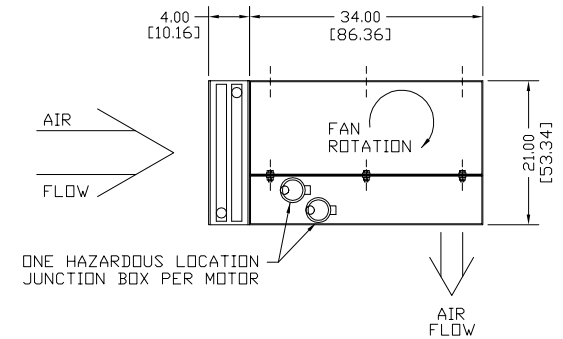

HLC20

HOT WATER HEATED FRONT INTAKE OPP. END SUP./RET. HAZARDOUS LOCATION

END VIEW

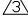
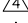
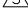
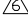

NOTES:

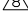
-  AIR CURTAIN MUST BE INSTALLED SO AIR STREAM IS NOT OBSTRUCTED WHEN DEFLECTED 20° TO EITHER SIDE OF C.
-  ELECTRICAL CONNECTIONS TO BE FLEXIBLE.
-  FIELD VERIFY DIMENSIONS.
-  ANCHORS TO SUPPORTING STRUCTURE BY OTHERS.
-  ADEQUACY OF SUPPORTING STRUCTURE IS TO BE VERIFIED BY A PROFESSIONAL STRUCTURAL ENGINEER.
-  LETTER "W" IN MODEL NUMBER DESIGNATES HOT WATER HEATED UNIT, THE "F" IS FOR FRONT INTAKE.
-  REMOTE OPTIONAL CONTROL PANEL AVAILABLE; NEMA 4/12 FOR NON HAZARDOUS LOCATION MOUNTING; NEMA 7/9 FOR HAZARDOUS LOCATION MOUNTING. PLEASE SPECIFY.
-  COIL CONNECTIONS AS SHOWN, OPPOSITE AND SAME END CONNECTIONS AVAILABLE, PLEASE SPECIFY.
-  DIMENSIONS IN INCHES [CENTIMETERS].

PROJECT		
LOCATION		
ARCHITECT		
ENGINEER		
DWG. NO.	HLC20-WTR4	TITLE: BERNER
DATE	18JUNE14	MODEL HLC20 AIR CURTAIN
BY	S. Beil	HAZARDOUS LOCATION FRONT INTAKE HOT WATER HEATED SYSTEM
REPLACES	-	
BY	-	BERNER INTERNATIONAL CORP. NEW CASTLE, PA.